

## INSTRUCTION FOR MAGNET ADJUSTMENT IN ENEO LOCK

**All work must be carried out in accordance with health and safety regulations and construction best practices by qualified personnel.**

The following instructions describe the procedure for adjusting the magnet that works with the built-in reed switch in the ENEO lock.

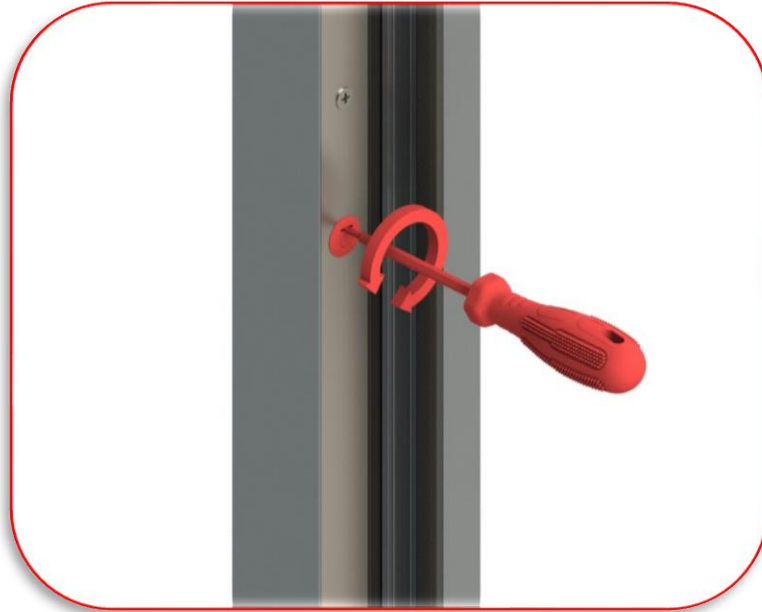

1. The ROTO ENEO CC electro-motorized strip is equipped with a built-in reed switch, whose purpose is to confirm the door's closure, ensuring the correct operation of the lock. The motor installed in the strip locks only when the reed switch confirms that the door is properly closed. This prevents the lock from engaging when the door is not in the correct position.
2. The magnet that works with the reed switch is located at the bottom of the latch strip, which is mounted on the door frame.
3. The magnet is eccentric, allowing for precise adjustment of its operational range.
4. **WARNING!** Before adjusting the magnet, ensure that the door has been properly aligned.
5. The magnet should be adjusted using a flathead screwdriver, turning it until the desired position is reached.
6. **WARNING!** Striking the magnet is not allowed.
7. **WARNING!** The built-in reed switch is for ensuring the proper operation of the lock only. It cannot be used to send signals to external devices or systems. If there is a need to output signals, an additional reed switch (available as an option) should be used.